

# Installation Guide

**NEWSTAR**  
Computerproducts

[www.newstar.nl](http://www.newstar.nl)

## LCD TV/Monitor wall mount



Model:  
FPMA-W25



FPMA-W25

10 mm

## Quick Mount LCD Monitor / TV Kit

Wall Plate

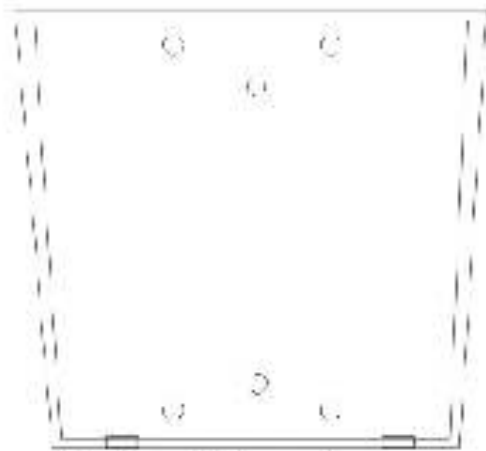

Use the 2½" wood screws, mount the wall plate to wall stud or use enclosed sheet rock mollys



*Note:* Bracket is intended for use on LCD monitors up to 66 lbs

LCD TV/Monitor Plate

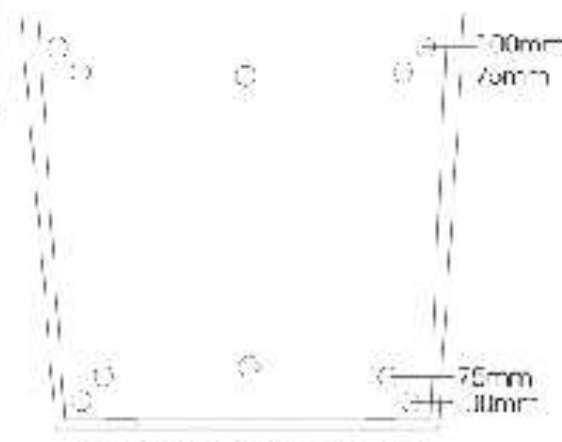

Use the ½" bolts, mount the monitor plate to back of monitor. (Note corners holes to accommodate both 75mm or 100mm VESA systems)



Use the ½" bolts to lock and secure your monitor in place

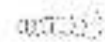

VESA® is a registered Trademark of the Video Electronics Standards Association

**CAUTION:** Do not exceed 30 kilo (66 Lbs) weight limit  
**LET OP:** Maximaal draagvermogen 30 kilo



FPMA-W25

10 mm

## As Easy as 1,2,3!

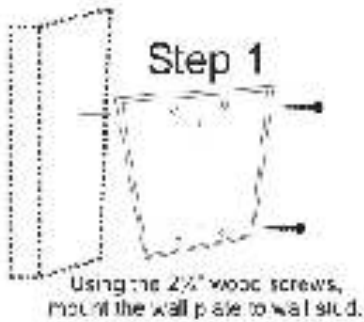

**Step 1**  
Using the 2 1/2" wood screws, mount the wall plate to wall stud.

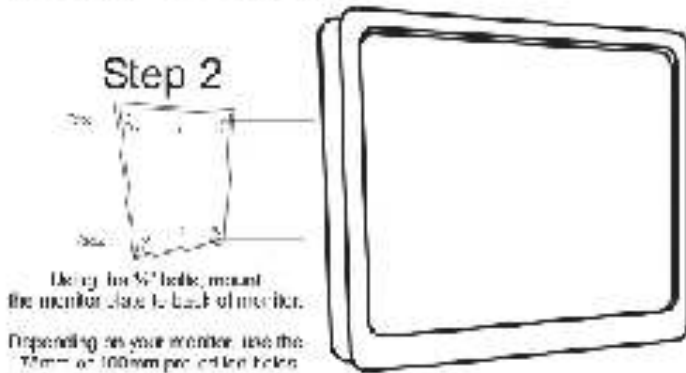

**Step 2**  
Using the 1/2" bolts, mount the monitor plate to back of monitor. Depending on your monitor use the 75mm or 100mm panel hole bolts.

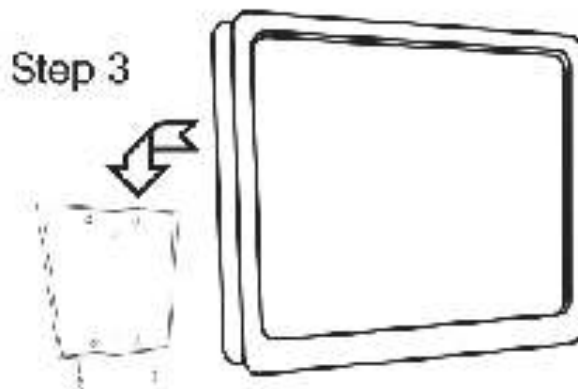

**Step 3**  
Simply slip your monitor onto your wall mount, and secure with 1/2" locking bolts from below, and you are finished! Enjoy!

**CAUTION:** Do not exceed 30 kilo (66 Lbs) weight limit  
**LET OP:** Maximaal draagvermogen 30 kilo



All Rights Reserved. Unauthorized Copying and Reproduction are prohibited.